

User Manual

Solar Street Light

210 mm

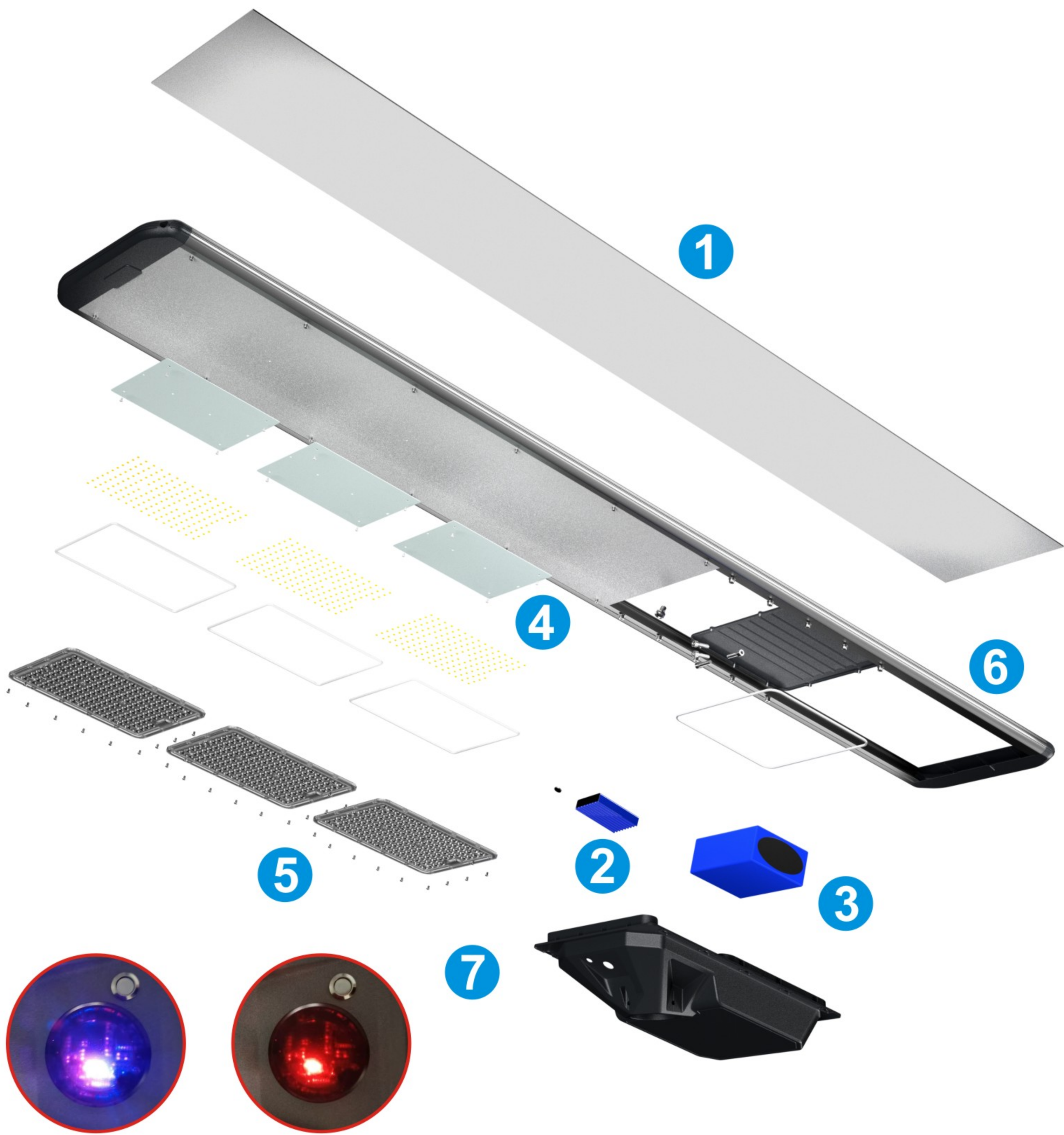

- 1 Mono Solar Panel
- 2 Control Module
- 3 LifePo4 Battery
- 4 LED Plate
- 5 Optical Len
- 6 Die-cast Aluminum Bracket
- 7 Red Point Always On Light: Battery have power
Red Point Flashing Slowly: Battery will power down soon
Red Point Flashing quickly: Controller are in short circuit
Green Point Flashing Slowly: The light in on charging
Red Point Flashing quickly: Almost Full Charge
Blue Point Always On Light: The led chip is 100% wattage on light
Blue Point Flashing Slowly: The led chip is 90%-20% wattage on light
Blue Point Flashing quickly: LED chip are in short circuit

How is the light working?

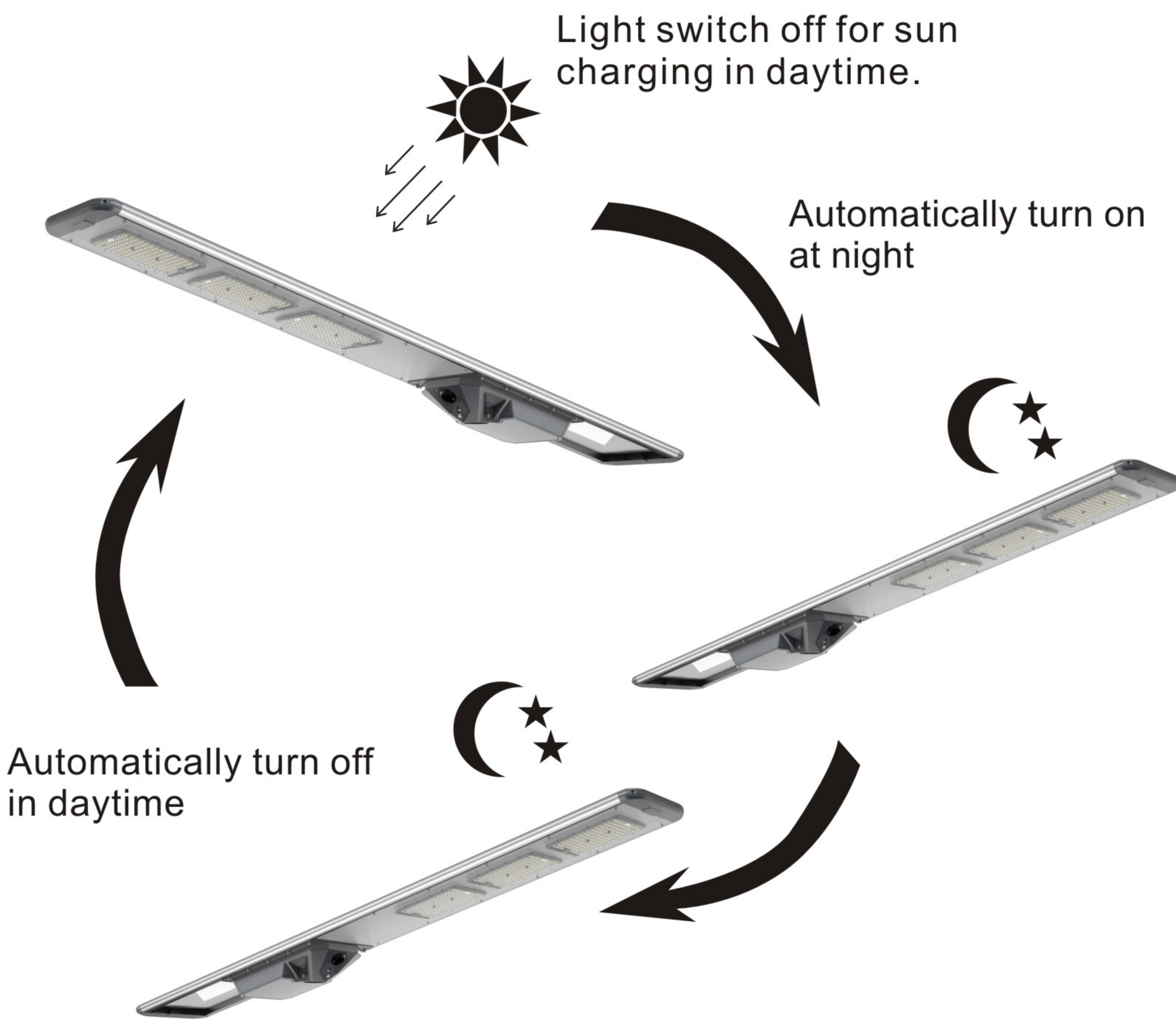

OFF
Light Off and won't on automatically anymore.

6H
6H/8H/12hrs lighting brightness

8H

12H

Demo
Brightness lighting for 2 minute

T
At night, 4 hrs full power+8hrs 25% Lighting

M
Motion sensor: 12 hrs motion sensor control

U
At night, 4 hrs full power+8hrs motion sensor control

Legend:
OFF: Light Off and won't on automatically anymore
6H/8H/12H: At night, 6H/8H/12hrs lighting
Demo: Brightness lighting for 2 minute
T: At night, 4hrs full power+ 8hrs 25% lighting
M: Motion sensor: 12hrs motion sensor control
U: At night, 4hrs full power+ 8hrs motion sensor control